

Locations for Sunday School 2017-2018

- | | | |
|--------------------------------|----------------------------|----------------------------------|
| Check In Station: 4A | 1st grade: 2A classroom | 7th-12th grades: |
| Check In Station: School Lobby | 2nd grade: 2B classroom | Youth Room in Family Life Center |
| 3 yr old: KA classroom | 3rd grade: 2C classroom | |
| 4 yr old: KC classroom | 4th grade: Spanish room | |
| Kindergarten: KB classroom | 5th & 6th grades: Art room | |

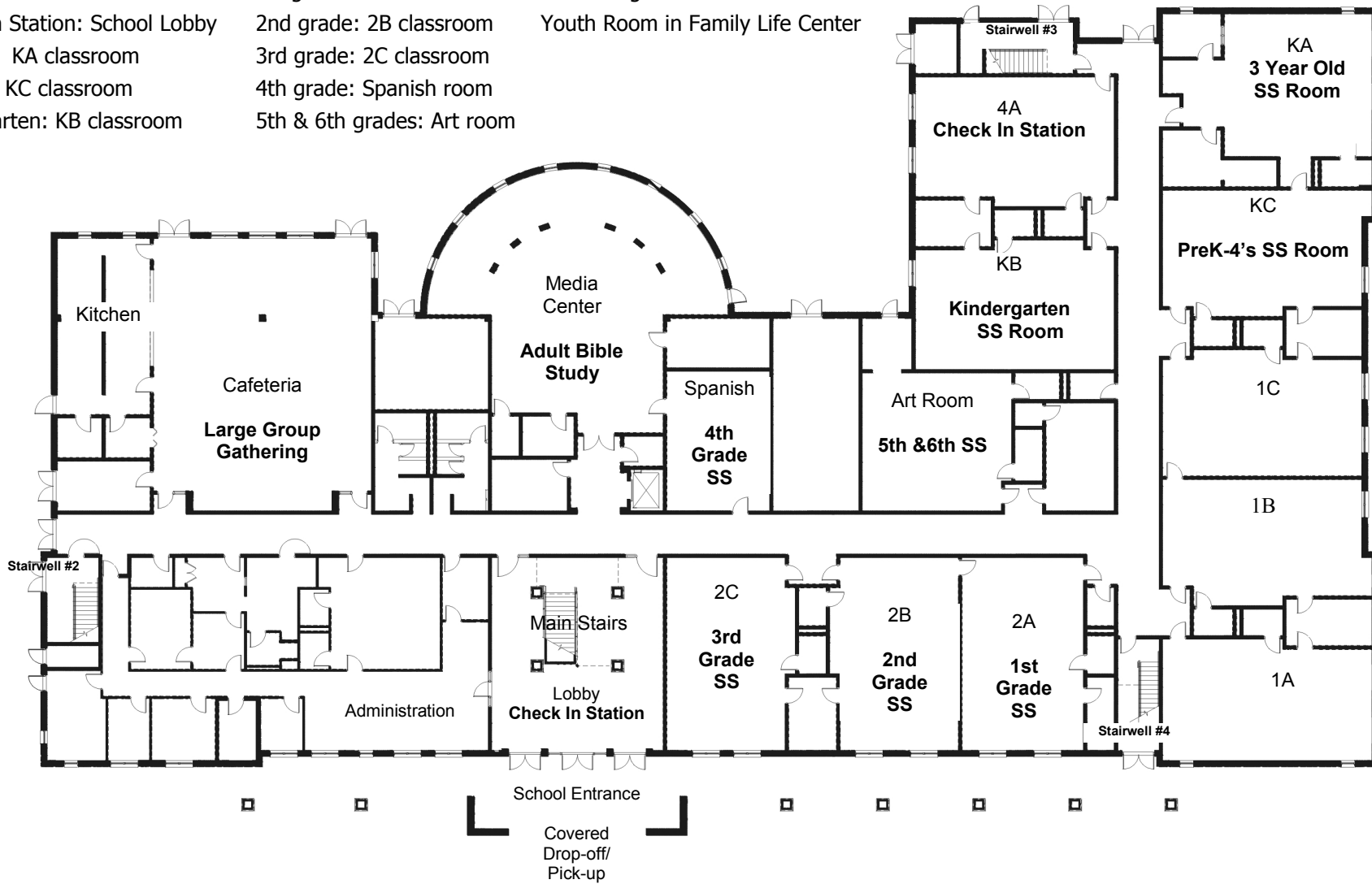

St. Luke's Lutheran School
FIRST FLOOR